

# GA Model

## Landing Gear Control

### Description

Kavlico's GA model provide all the necessary elements for control while providing signal indication via internal control switches. Our GA model Landing Gear Control (LGC) unit meets the small envelope, minimum weight, and high reliability demanded by the aerospace industry in part by utilizing a well-known military standard for designing components.

The design of this LGC contains many features common to Kavlico's overall Landing Gear Control products, whose reliability and durability have been verified through extensive qualification testing.

Operation of the control handle actuates six control (single pole, double throw) switches for signaling position status. These signals occur when the handle is in either the stowed position of Up or DN. The electrical signals initiate the deployment or retraction of the landing gear system.

A spring loaded snap over center mechanism insures full handle travel into the UP and DN positions.

An electrically operated down-lock prevents movement of the control handle to the gear up position until the aircraft becomes airborne. The down-lock is operated by a continuous-duty rated solenoid. A manual override permits emergency release of the handle lock.

An ergonomic, easy-to-use wheel shaped control knob has been installed as per FAR Part 25 regulations.

Both the light plate and solenoid receive power through a Mil Std connector per D38999 Series III. The integrally mounted light plate design is manufactured in accordance with SAE 7788 Type VII. Additionally, the light plate provides the identification legends for the control handle Up and DN positions and for the down-lock release button.



### Features

- Electrically Controlled Down Latch
- Redundant Control Switches
- Design Meets FAR Part 25 and RTCA-160
- 80,000 flight hours MTBF
- Designed for 4-captive Quick Turn Fasteners
- Emergency Latch Override Button

# GA Model

## Landing Gear Control

### Specifications

Inadvertency Protection:	Continuous duty solenoid down-lock with manual over-ride
Operating Force:	2.5 to 5 lbs. (11 to 22N)
Travel Output – Mechanical:	40 degrees
Control Knob:	Wheel shaped per Far Part 25.781, color 37875
Panel Illumination:	SAE 7788, Type VII (LED), 5VDC
Control Switches:	Gold Plated, sealed (6 each)
Electrical Receptacle:	Mil Std. D38999/20FD35PN
Color Scheme:	Fed-Std 595, color 36118 (lusterless gray)
Markings:	Color 37875 (White)
Weight:	1.76 lbs. (0.8 Kg.) Max.

### Cut Out Dimensions

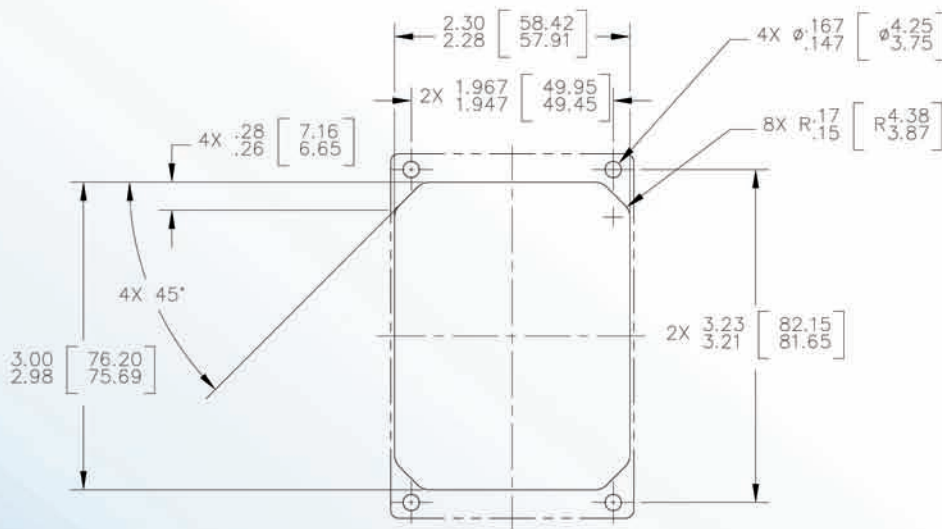

RECOMMENDED PANEL CUTOUT

### Schematic

